

# Profile AIR TOP AT02

**BILTON**

FOCUSED  
ON  
LINEAR  
LIGHT

BL AIR surface-mounted profile plastic white grey for AIR Top L2000mm

Article no.: 170885

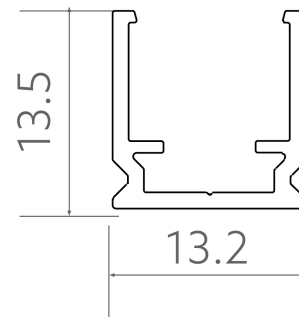

Mounting method



Height



Width

---

## TENDER TEXT

LED plastic profile for AIR TOP L 2000 x W 13.2 x H 14 mm, white-grey, opaque, with adhesive tape BILTON LEDON Technology Profile AIR TOP AT02  
Article 170885 The Profile AIR TOP AT02 consists of Plastic and has a reinweiß surface. Dimension (L x W x H): 2000.0 mm x 13.2 mm x 14.0 mm

---

# Profile AIR TOP AT02

**BILTON**FOCUSED  
ON  
LINEAR  
LIGHT**BL AIR surface-mounted profile plastic white grey for AIR Top L2000mm**

Article no.: 170885

## MECHANICAL DATA

|                    |          |
|--------------------|----------|
| Net width [mm]     | 13.2     |
| Net height [mm]    | 14.0     |
| Net length [mm]    | 2000.0   |
| Colour             | reinweiß |
| Mounting method    | Other    |
| Surface protection | Other    |
| Net weight [g]     | 120      |
| Material           | Plastic  |

## TEMPERATURE TECHNICAL DATA

|                      |      |
|----------------------|------|
| Thermal conductivity | 70.0 |
|----------------------|------|

## PACKAGING INFORMATION

|                       |               |
|-----------------------|---------------|
| EAN                   | 4250716933031 |
| Article no.           | 170885        |
| Customs tariff number | 39169090      |
| Length [mm]           | 2000.0        |
| Gross weight [g]      | 120.0         |
| Gross height [mm]     | 14.0          |
| Gross width [mm]      | 13.2          |
| Gross length [mm]     | 2000.0        |
| State of origin       | DE            |

SAFETY INFORMATION: Read the safety and installation instructions carefully and completely before commissioning. The operating instructions can be found at: [www.biltongroup.com](http://www.biltongroup.com)

DISCLAIMER OF WARRANTY: The technical information corresponds to the status at the time of printing and have been worked out to the best of our knowledge. However, errors and printing errors are reserved. Make sure that you always use the latest version of the data sheets. The latest data sheet can be found at: [www.biltongroup.com](http://www.biltongroup.com)